

FORCE DE POUSSEE - OUTPUT FORCE - FUERZA DE EMPUJE

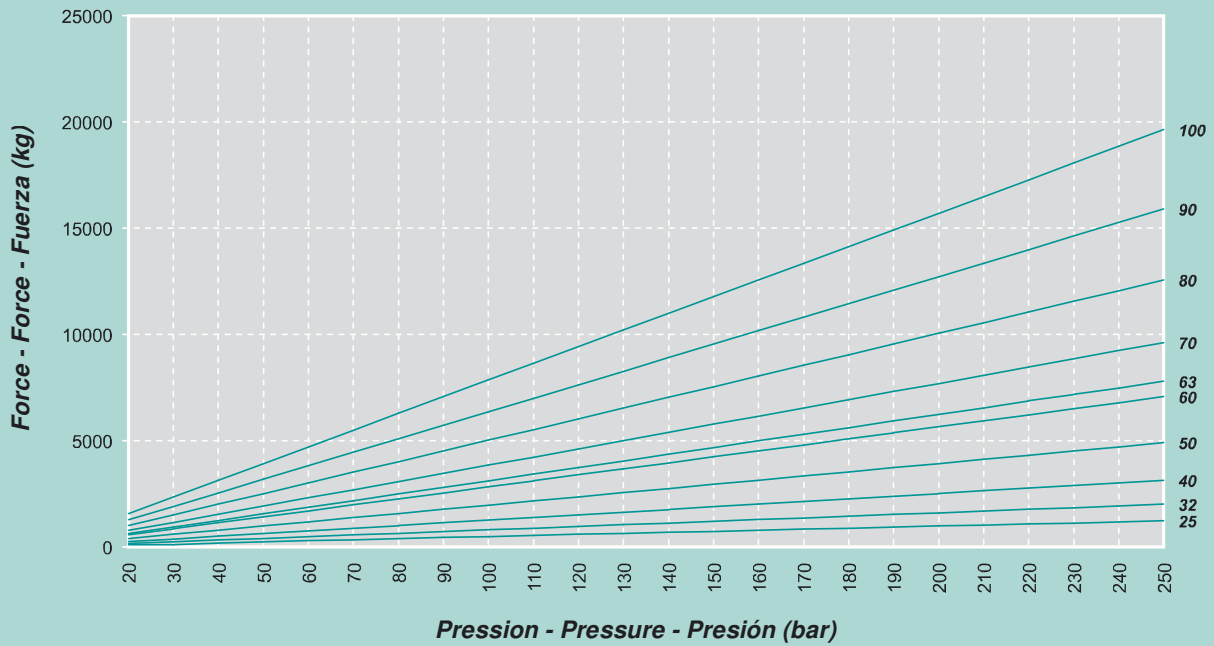

FORCE DE TRACTION - INPUT FORCE - FUERZA DE TRACCION

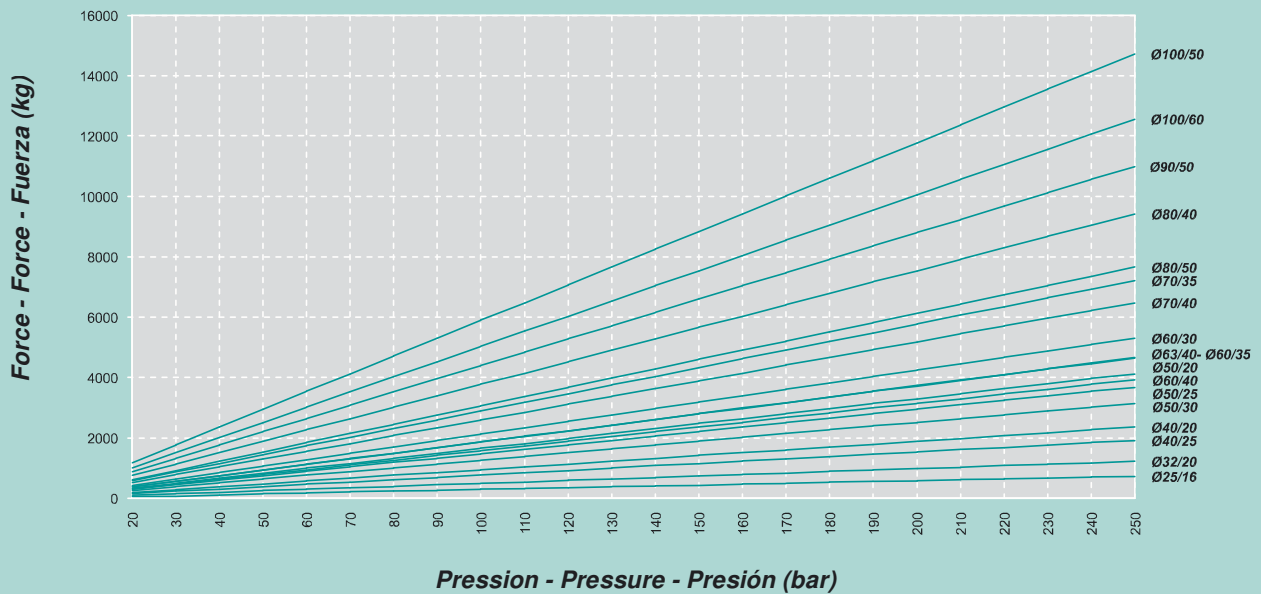

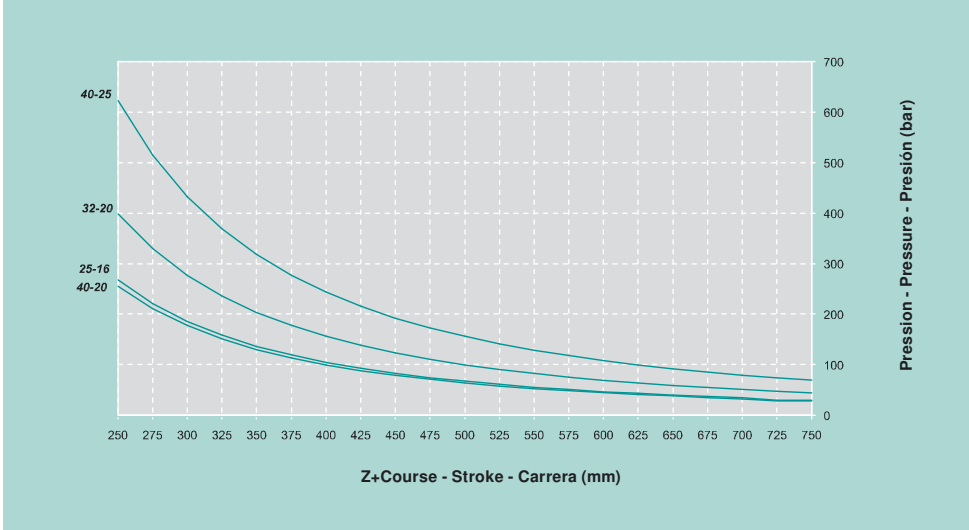

FLAMBAGE TIGE VERINS
STANDARD TYPE HMO
(Alésage 25-32-40 mm)

COMBINED COMPRESSIVE AND
BENDING STRESS ON STANDARD
CYLINDERS HMO TYPE
(Bore 25-32-40 mm)

CARGA DE PICO CILINDROS
ESTANDAR TIPO HMO
(dia. Interior 25-32-40 mm)

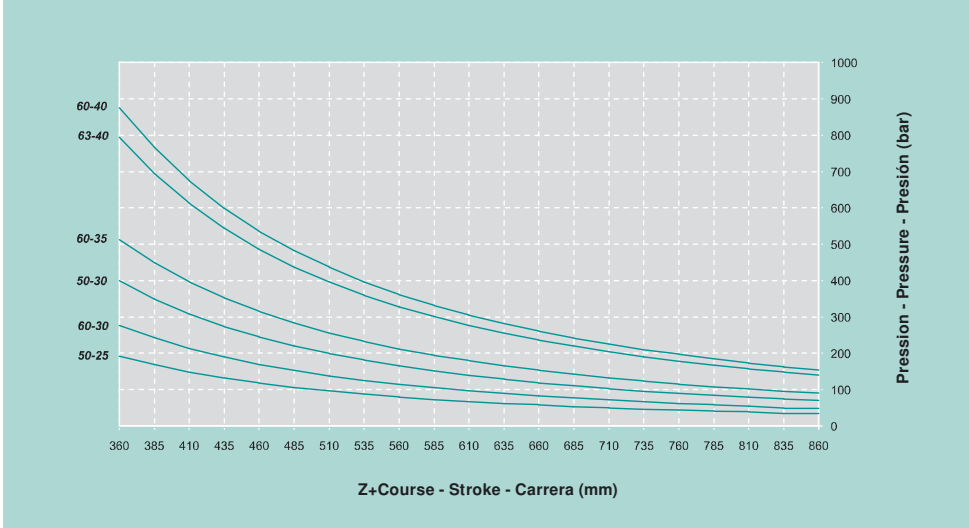

FLAMBAGE TIGE VERINS
STANDARD TYPE HMO
(Alésage 50-60-63 mm)

COMBINED COMPRESSIVE AND
BENDING STRESS ON STANDARD
CYLINDERS HMO
TYPE (Bore 50-60-63

CARGA DE PICO CILINDROS
ESTANDAR TIPO HMO
(dia. Interior 50-60-63 mm)

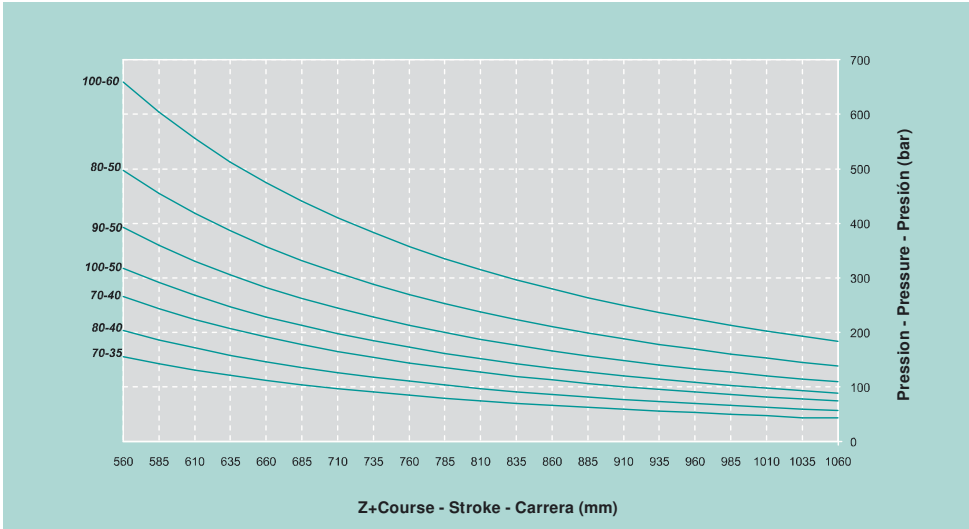

FLAMBAGE TIGE VERINS
STANDARD TYPE HMO
(Alésage 70-80-90-100 mm)

COMBINED COMPRESSIVE AND
BENDING STRESS ON STANDARD
CYLINDERS HMO TYPE
(Bore 70-80-90-100 mm)

CARGA DE PICO CILINDROS
ESTANDAR TIPO HMO
(dia. Interior 70-80-90-100 mm)

TYPE "HMO" - "HMOLM"

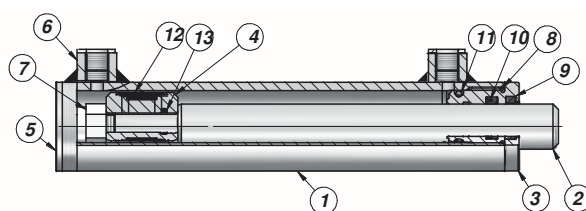

"HMO" Pression Maxi - Max. Pressure - Presión Máxima: 210 Bar
"HMOLM" Pression Maxi - Max. Pressure - Presión Máxima: 180 Bar

TYPE "HFR2S"

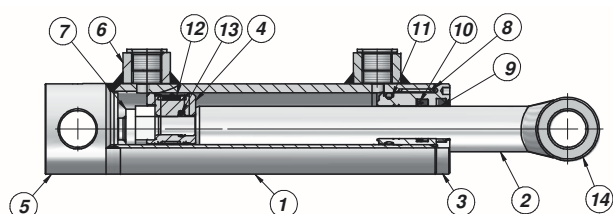

"HFR2S" Pression Maxi - Max. Pressure - Presión Máxima: 210 Bar

TYPE "HMF"

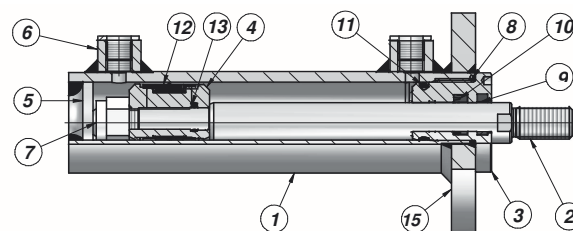

"HMF" Pression Maxi - Max. Pressure - Presión Máxima: 210 Bar

1	TUBE GLACE POLISHED TUBE - TUBO LUCIDO	ACIER - STEEL - ACERO: St 52.3 DIN 2393 ISO H9
2	TIGE CHROME CHROMED ROD - BARRACROMADA	ACIER - STEEL - ACERO: UNI C45 - SAE 1045 CHROME - CHROME - CROMO: 25 Micron ±5
3	TETE DE GUIDAGE HEAD-BUSH - CABEZA GUIA	FONTE - HYDRAULICCAST IRON - HIERRO FUNDIDO: UNI 5007-G25
4	PISTON	ACIER - STEEL - ACERO: 9SMn28
5	FOND - END-PLUG - FONDO	ACIER - STEEL - ACERO: S355J0 (Fe510C) - S355JR(A105)
6	BOSSAGE TARAUDE THREADED PORT - MANGUITOROSCADO	ACIER - STEEL - ACERO: 9SMn28
7	ECROU DE BLOCAGE PISTON LOCKNUT - TUERCA	ACIER - STEEL - ACERO: UNI 7473 - 7474
8	JOINT - SEAL - JUNTA O-RING	NBR 70 SHORE
9	JOINT - SEAL - JUNTA "GHK"	POLYURETHANE - POLYURETHANE - POLIURETANO
10	JOINT - SEAL - JUNTA "TSE-TTS-TTI/L"	"TSE": NBR+TISSU - NBR+FABRIC - NBR+TEJIDO "TTS-TTI/L": POLYURETHANE - POLYURETHANE - POLIURETANO
11	JOINT - SEAL - JUNTA O-RING	NBR 70 SHORE
12	JOINT - SEAL - JUNTA "TPM"	NBR+POM+POLYESTER - NBR+POM+POLYESTER - NBR+POLIÉSTER
13	JOINT - SEAL - JUNTA O-RING	NBR 70 SHORE
14	DOUILLE - BUSH - CASQUILLO PARA SOLDAR	ACIER - STEEL - ACERO: S355J0 (Fe510C)
15	BRIDE - FLANGE - BRIDA	ACIER - STEEL - ACERO: S355J0 (Fe510C)

Vitesse Maxi - Top Speed - Velocidad de pico: max 0,5 m/s
Température C° - Temperature C° - Temperatura C°: -25°C - +80°C

TYPE "HTO"

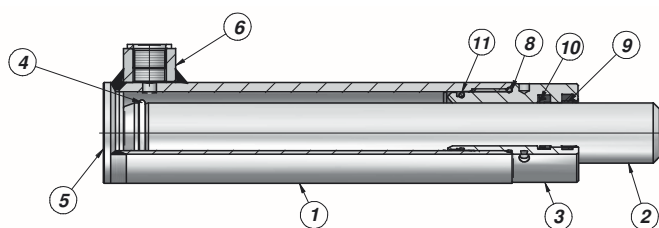

"HTO" Pression Maxi - Max. Pressure - Presión Máxima: 210 Bar

TYPE "HFRT"

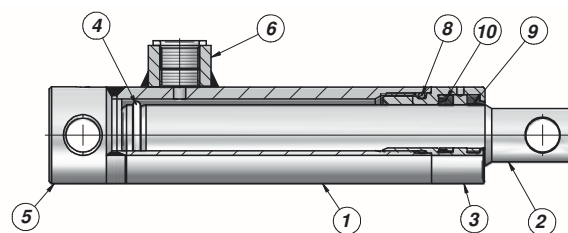

"HFRT" Pression Maxi - Max. Pressure - Presión Máxima: 210 Bar

1	TUBE GLACE POLISHED TUBE - TUBO LUCIDO	ACIER - STEEL - ACERO: St 52.3 DIN 2393 ISO H9
2	TIGE CHROMEE CHROMED ROD - BARRACROMADA	ACIER - STEEL - ACERO: UNI C45 - SAE 1045 CHROME - CHROME - CROMO: 25 Micron ±5
3	TETE DE GUIDAGE HEAD-BUSH - CABEZA GUIA TYPE - TYPE - TIPO: "HTO"	FONTE - HYDRAULICCAST IRON - HIERRO FUNDIDO: UNI 5007-G25
3	TETE DE GUIDAGE HEAD-BUSH - CABEZA GUIA TYPE - TYPE - TIPO: "HFRT"	ACIER 9SMn28 AVEC TRAITEMENT "NI-TEMPER" STEEL 9SMn28 WITH "NI-TEMPER" TREATMENT ACERO 9SMn28 CON TRATAMIENTO "NI-TEMPER"
4	JONC D'ARRETTIGE - STOP RING - ANILLO DE BLOQUEO	ACIER - STEEL - ACERO:
5	FOND - END-PLUG - FONDO	ACIER - STEEL - ACERO: S355J0 (Fe510C) - S355JR (A105)
6	BOSSAGE TARAUDE THREADED PORT - MANGUITO ROSCADO	ACIER - STEEL - ACERO: 9SMn28
8	JOINT - SEAL - JUNTA TIPO - TYPE - TYP: "HTO" O-RING	NBR 70 SHORE
8	JOINT - SEAL - JUNTA TIPO - TYPE - TYP: "HFRT" O-RING	NBR 90 SHORE
9	JOINT - SEAL - JUNTA "GHK"	POLYURETHANE - POLYURETHANE - POLIURETANO
10	JOINT - SEAL - JUNTA "TSE-TTS-TTI/L"	"TSE": NBR+TISSU - NBR+FABRIC - NBR+TEJIDO "TTS-TTI/L": POLYURETHANE - POLYURETHANE - POLIURETANO
11	JOINT - SEAL - JUNTA O-RING	NBR 70 SHORE

Vitesse Maxi - Top Speed - Velocidad de pico: max 0,5 m/s
Température C° - Temperature C° - Temperatura C°: -25°C - +80°C

M250

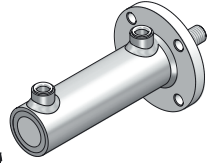
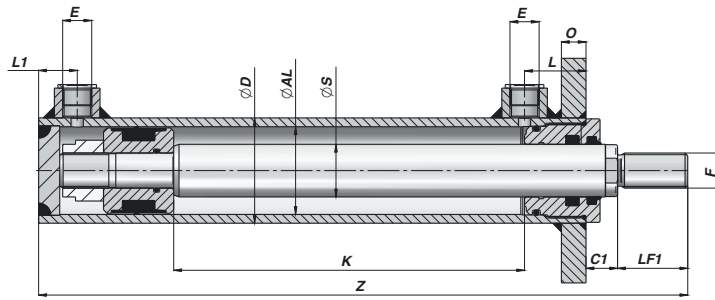
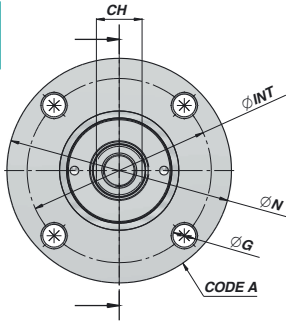

Code Code Código	K	Z	kg	E BSP	L	L1	F	LF1	CH	C1	ØN	ØINT	ØG	O	Code A
ØD 50 ØAL 40 ØS 20															
HMF1200100	100	250	3,00												CFLO050109
HMF1200200	200	350	3,80												
HMF1200300	300	450	4,60	1/4"	32	25	M16x1,5	30	18	18	109	87	Ø 11 x 4	12	
HMF1200400	400	550	5,40												
HMF1200500	500	650	6,20												
ØD 60 ØAL 50 ØS 30															
HMF2300100	100	270	4,60												CFLO060128
HMF2300200	200	370	5,80												
HMF2300300	300	470	7,00	3/8"	35	25	M20x1,5	40	26	18	128	105	Ø 13 x 4	14	
HMF2300400	400	570	8,20												
HMF2300500	500	670	9,40												
ØD 70 ØAL 60 ØS 35															
HMF3350100	100	300	6,90												CFLO070142
HMF3350200	200	400	8,40												
HMF3350300	300	500	9,90	3/8"	40	30	M27x2	50	32	20	142	117	Ø 13 x 4	16	
HMF3350400	400	600	11,40												
HMF3350500	500	700	12,90												
ØD 80 ØAL 70 ØS 40															
HMF4400100	100	312	8,63												CFLO080162
HMF4400200	200	412	10,53												
HMF4400300	300	512	12,76	3/8"	40	30	M30x2	60	36	22	162	127	Ø 15 x 4	16	
HMF4400400	400	612	15,00												
HMF4400500	500	712	17,20												
ØD 95 ØAL 80 ØS 50															
HMF5500100	100	345	13,70												CFLO095181
HMF5500200	200	445	16,80												
HMF5500300	300	545	19,90	1/2"	50	40	M36x2	70	45	25	181	149	Ø 17 x 6	18	
HMF5500400	400	645	23,00												
HMF5500500	500	745	26,10												
ØD 115 ØAL 100 ØS 50															
HMF6500100	100	375	20,20												CFLO115194
HMF6500200	200	475	25,80												
HMF6500300	300	575	27,20	1/2"	70	40	M36x2	70	45	27	194	162	Ø 17 x 6	24	
HMF6500400	400	675	30,80												
HMF6500500	500	775	34,40												

MATERIEL - MATERIAL:

TUBE - TUBE - TUBO: ACIER - STEEL - ACERO S1 52.3 DIN 2393 ISO H9

TIGE - ROD - VASTAGO: ACIER - STEEL - ACERO UNI C45 SAE 1045 - CHROME - CHROME - CROMO: 25 MICRON ±5