

**FORCE DE POUSSEE - OUTPUT FORCE - FUERZA DE EMPUJE**

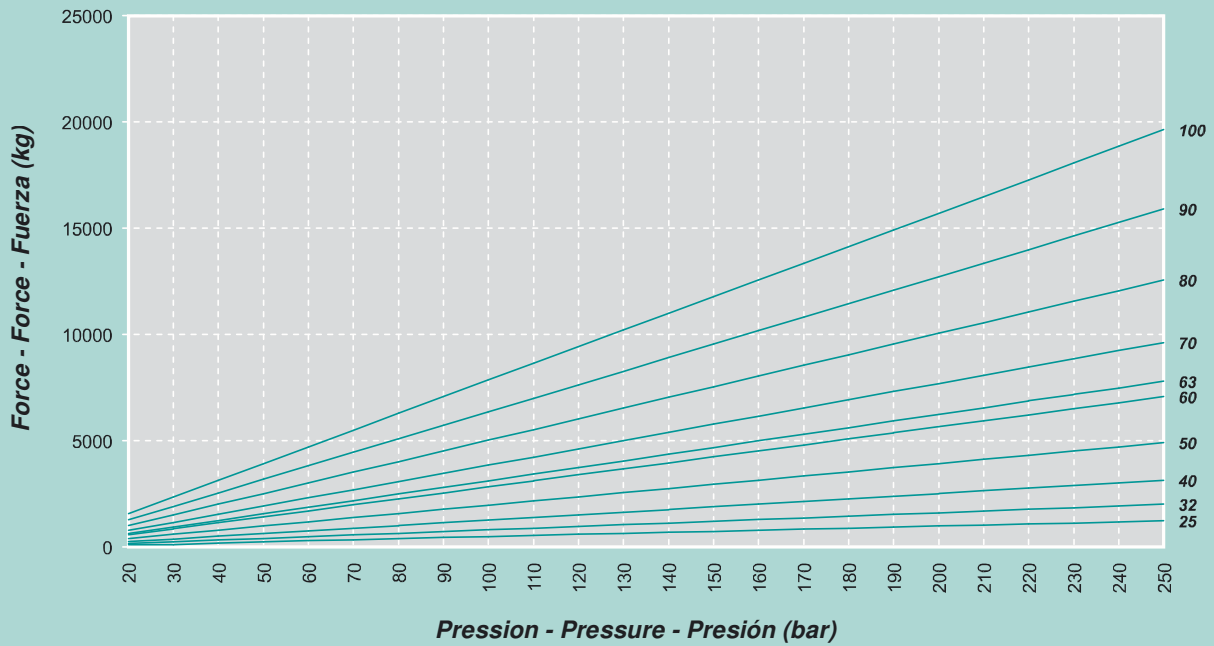

**FORCE DE TRACTION - INPUT FORCE - FUERZA DE TRACCION**

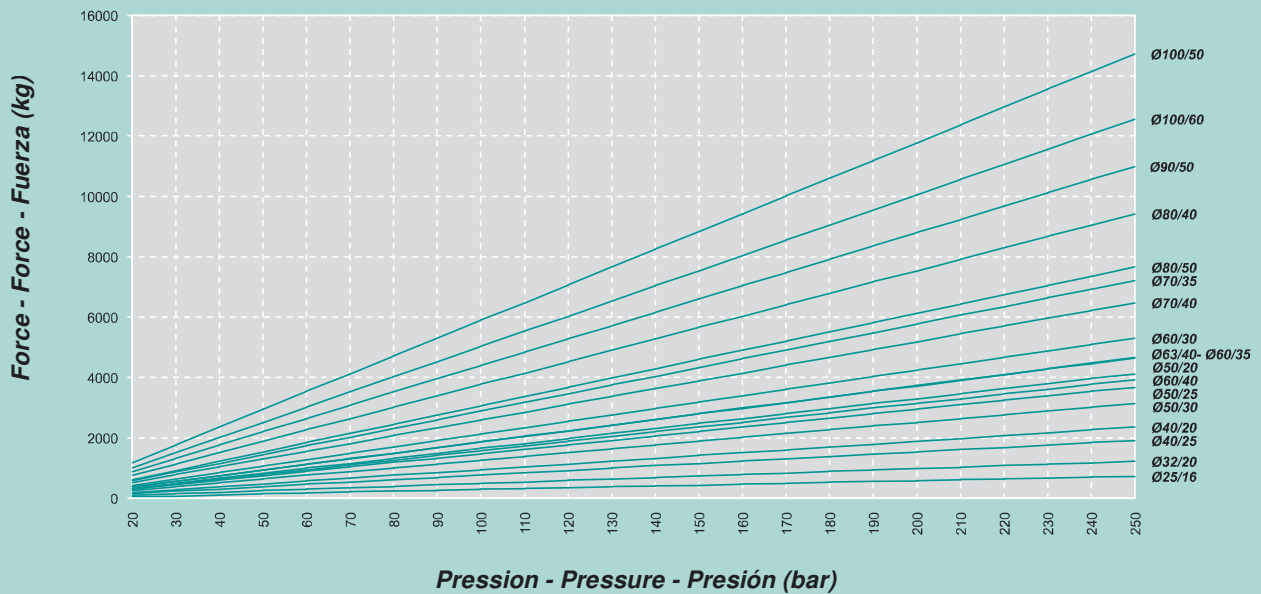

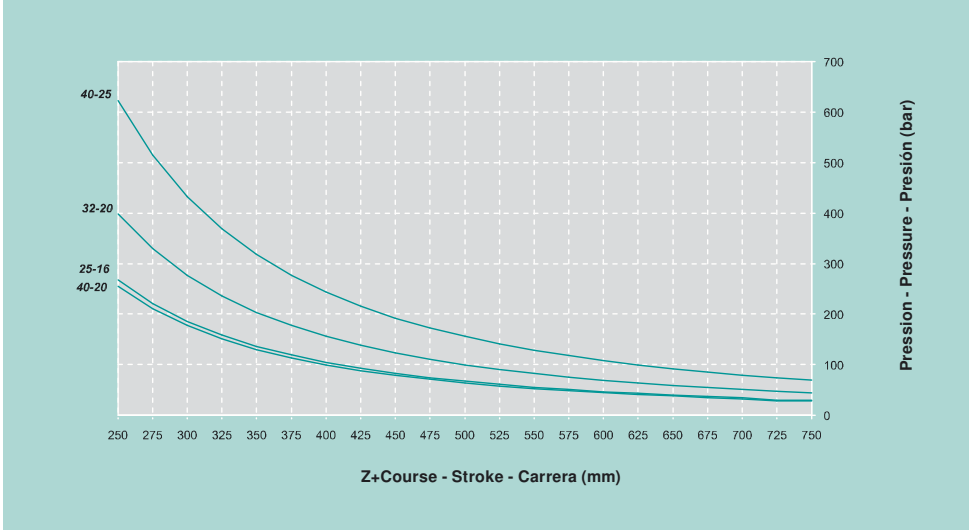

FLAMBAGE TIGE VERINS  
STANDARD TYPE HMO  
(Alésage 25-32-40 mm)

COMBINED COMPRESSIVE AND  
BENDING STRESS ON STANDARD  
CYLINDERS HMO TYPE  
(Bore 25-32-40 mm)

CARGA DE PICO CILINDROS  
ESTANDAR TIPO HMO  
(dia. Interior 25-32-40 mm)

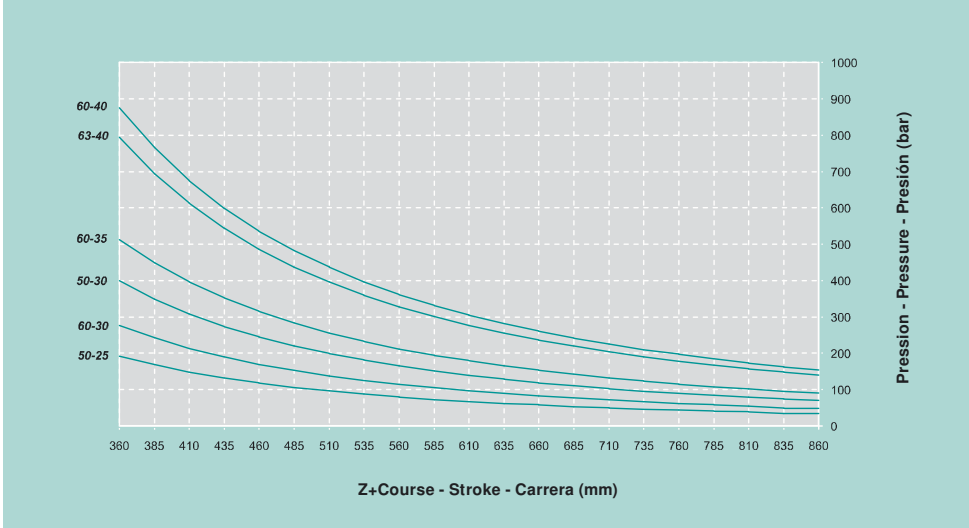

FLAMBAGE TIGE VERINS  
STANDARD TYPE HMO  
(Alésage 50-60-63 mm)

COMBINED COMPRESSIVE AND  
BENDING STRESS ON STANDARD  
CYLINDERS HMO  
TYPE (Bore 50-60-63 mm)

CARGA DE PICO CILINDROS  
ESTANDAR TIPO HMO  
(dia. Interior 50-60-63 mm)

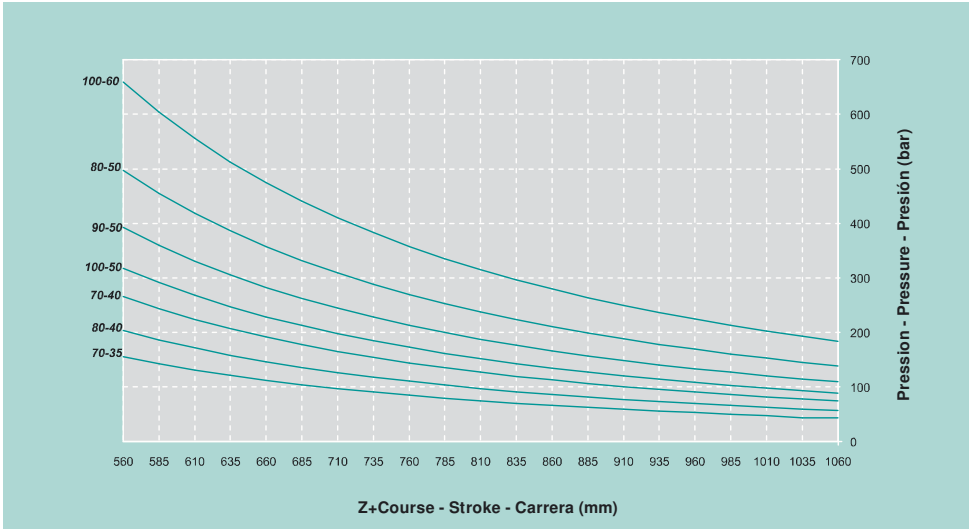

FLAMBAGE TIGE VERINS  
STANDARD TYPE HMO  
(Alésage 70-80-90-100 mm)

COMBINED COMPRESSIVE AND  
BENDING STRESS ON STANDARD  
CYLINDERS HMO TYPE  
(Bore 70-80-90-100 mm)

CARGA DE PICO CILINDROS  
ESTANDAR TIPO HMO  
(dia. Interior 70-80-90-100 mm)

TYPE "HMO" - "HMOLM"

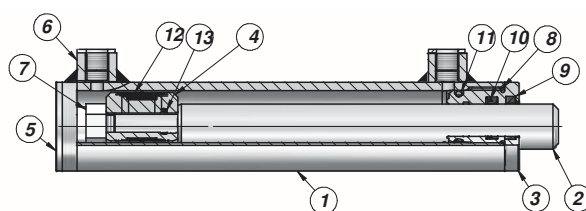

"HMO" Pression Maxi - Max. Pressure - Presión Máxima: 210 Bar  
"HMOLM" Pression Maxi - Max. Pressure - Presión Máxima: 180 Bar

TYPE "HFR2S"

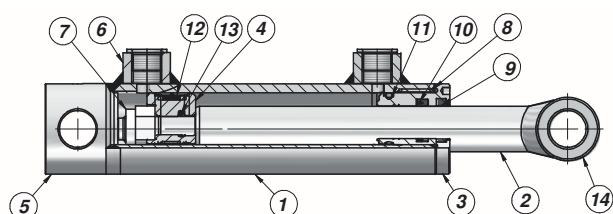

"HFR2S" Pression Maxi - Max. Pressure - Presión Máxima: 210 Bar

TYPE "HMF"

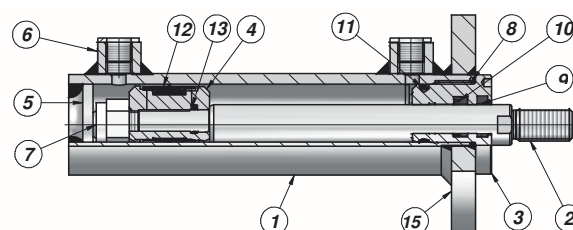

"HMF" Pression Maxi - Max. Pressure - Presión Máxima: 210 Bar

1	TUBE GLACE POLISHED TUBE - TUBO LUCIDO	ACIER - STEEL - ACERO: St 52.3 DIN 2393 ISO H9
2	TIGE CHROME CHROMED ROD - BARRACROMADA	ACIER - STEEL - ACERO: UNI C45 - SAE 1045 CHROME - CHROME - CROMO: 25 Micron ±5
3	TETE DE GUIDAGE HEAD-BUSH - CABEZA GUIA	FONTE - HYDRAULICCAST IRON - HIERRO FUNDIDO: UNI 5007-G25
4	PISTON	ACIER - STEEL - ACERO: 9SMn28
5	FOND - END-PLUG - FONDO	ACIER - STEEL - ACERO: S355J0 (Fe510C) - S355JR(A105)
6	BOSSAGE TARAUDE THREADED PORT - MANGUITOROSCADO	ACIER - STEEL - ACERO: 9SMn28
7	ECROU DE BLOCAGE PISTON LOCKNUT - TUERCA	ACIER - STEEL - ACERO: UNI 7473 - 7474
8	JOINT - SEAL - JUNTA O-RING	NBR 70 SHORE
9	JOINT - SEAL - JUNTA "GHK"	POLYURETHANE - POLYURETHANE - POLIURETANO
10	JOINT - SEAL - JUNTA "TSE-TTS-TTI/L"	"TSE": NBR+TISSU - NBR+FABRIC - NBR+TEJIDO "TTS-TTI/L": POLYURETHANE - POLYURETHANE - POLIURETANO
11	JOINT - SEAL - JUNTA O-RING	NBR 70 SHORE
12	JOINT - SEAL - JUNTA "TPM"	NBR+POM+POLYESTER - NBR+POM+POLYESTER - NBR+POLIÉSTER
13	JOINT - SEAL - JUNTA O-RING	NBR 70 SHORE
14	DOUILLE - BUSH - CASQUILLO PARA SOLDAR	ACIER - STEEL - ACERO: S355J0 (Fe510C)
15	BRIDE - FLANGE - BRIDA	ACIER - STEEL - ACERO: S355J0 (Fe510C)

Vitesse Maxi - Top Speed - Velocidad de pico: max 0,5 m/s  
Température C° - Temperature C° - Temperatura C°: -25°C - +80°C

TYPE "HTO"

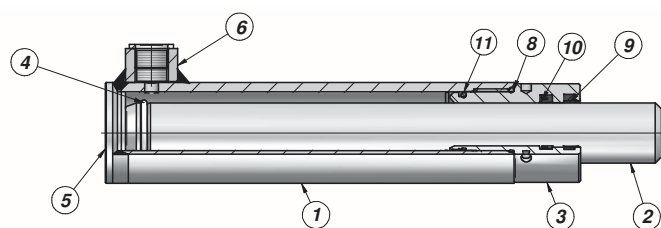

"HTO" Pression Maxi - Max. Pressure - Presión Máxima: 210 Bar

TYPE "HFRT"

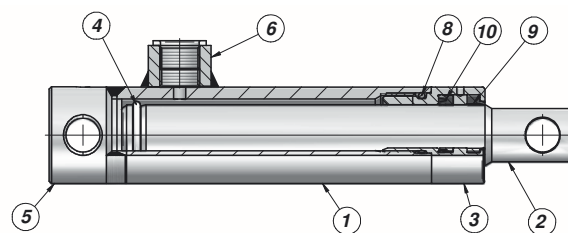

"HFRT" Pression Maxi - Max. Pressure - Presión Máxima: 210 Bar

1	TUBE GLACE POLISHED TUBE - TUBO LUCIDO	ACIER - STEEL - ACERO: St 52.3 DIN 2393 ISO H9
2	TIGE CHROMEE CHROMED ROD - BARRACROMADA	ACIER - STEEL - ACERO: UNI C45 - SAE 1045 CHROME - CHROME - CROMO: 25 Micron ±5
3	TETE DE GUIDAGE HEAD-BUSH - CABEZA GUIA TYPE - TYPE - TIPO: "HTO"	FONTE - HYDRAULICCAST IRON - HIERRO FUNDIDO: UNI 5007-G25
3	TETE DE GUIDAGE HEAD-BUSH - CABEZA GUIA TYPE - TYPE - TIPO: "HFRT"	ACIER 9SMn28 AVEC TRAITEMENT "NI-TEMPER" STEEL 9SMn28 WITH "NI-TEMPER" TREATMENT ACERO 9SMn28 CON TRATAMIENTO "NI-TEMPER"
4	JONC D'ARRETTIGE - STOP RING - ANILLO DE BLOQUEO	ACIER - STEEL - ACERO:
5	FOND - END-PLUG - FONDO	ACIER - STEEL - ACERO: S355J0 (Fe510C) - S355JR (A105)
6	BOSSAGE TARAUDE THREADED PORT - MANGUITO ROSCADO	ACIER - STEEL - ACERO: 9SMn28
8	JOINT - SEAL - JUNTA TIPO - TYPE - TYP: "HTO" O-RING	NBR 70 SHORE
8	JOINT - SEAL - JUNTA TIPO - TYPE - TYP: "HFRT" O-RING	NBR 90 SHORE
9	JOINT - SEAL - JUNTA "GHK"	POLYURETHANE - POLYURETHANE - POLIURETANO
10	JOINT - SEAL - JUNTA "TSE-TTS-TTI/L"	"TSE": NBR+TISSU - NBR+FABRIC - NBR+TEJIDO "TTS-TTI/L": POLYURETHANE - POLYURETHANE - POLIURETANO
11	JOINT - SEAL - JUNTA O-RING	NBR 70 SHORE

Vitesse Maxi - Top Speed - Velocidad de pico: max 0,5 m/s  
Température C° - Temperature C° - Temperatura C°: -25°C - +80°C

M250

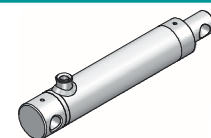
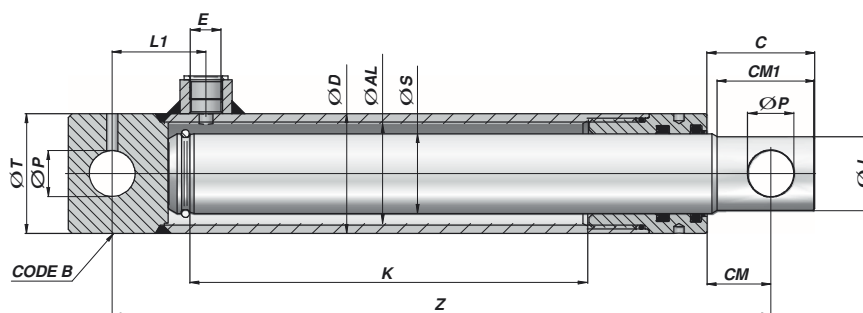

Code Code Código	K	Z	kg	E BSP	L1	ØP	CM	C	ØJ	CM1	ØT	Code B
<b>ØD 40    ØAL 30    ØS 25</b>												
HFRT125100	100	190	1,63	3/8"	40	14	24	38	22	35	40	CFHRT04030
HFRT125150	150	240	2,04									
HFRT125200	200	290	2,44									
HFRT125250	250	340	2,85									
HFRT125300	300	390	3,26									
<b>ØD 50    ØAL 40    ØS 30</b>												
HFRT230200	200	300	3,61	3/8"	42	16	26	42	27	37	50	CF04005016
HFRT230250	250	350	4,16									
HFRT230300	300	400	4,72									
HFRT230350	350	450	5,27									
HFRT230400	400	500	5,82									
HFRT230550	550	650	7,30									
<b>ØD 60    ØAL 50    ØS 40</b>												
HFRT340200	200	330	6,00	3/8"	47	23	32	54	37	49	60	CFHRT06050
HFRT340250	250	380	6,84									
HFRT340300	300	430	7,67									
HFRT340350	350	480	8,49									
HFRT340400	400	530	9,32									
HFRT340550	550	680	11,70									
HFRT340700	700	830	14,10									
<b>ØD 70    ØAL 60    ØS 50</b>												
HFRT450300	300	460	11,80	3/8"	50	25,5	49	74	47	65	65	CFHRT07060
HFRT450400	400	560	14,00									
HFRT450550	550	710	17,50									
HFRT450700	700	860	21,00									

MATERIEL - MATERIAL:

TUBE - TUBE - TUBO: ACIER - STEEL - ACERO St 52.3 DIN 2393 ISO H9

TIGE - ROD - VASTAGO: ACIER - STEEL - ACERO UNI C45 SAE 1045 - CHROME - CHROME - CROMO: 25 MICRON ±5