

FORCE DE POUSSEE - OUTPUT FORCE - FUERZA DE EMPUJE

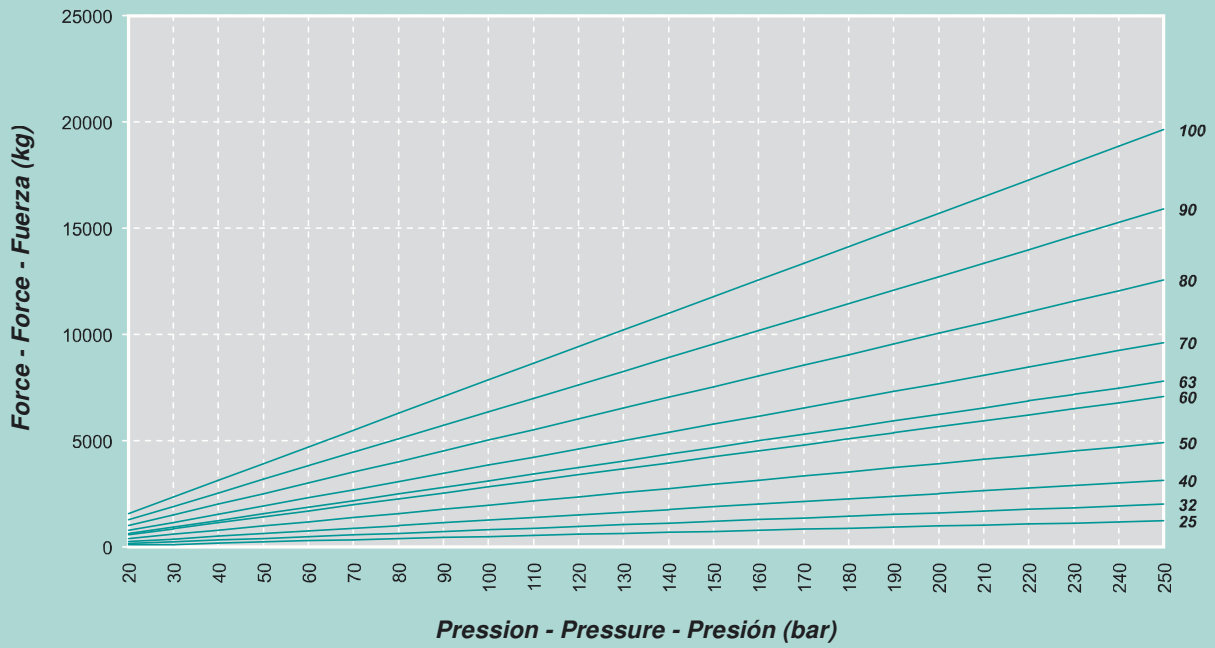

FORCE DE TRACTION - INPUT FORCE - FUERZA DE TRACCION

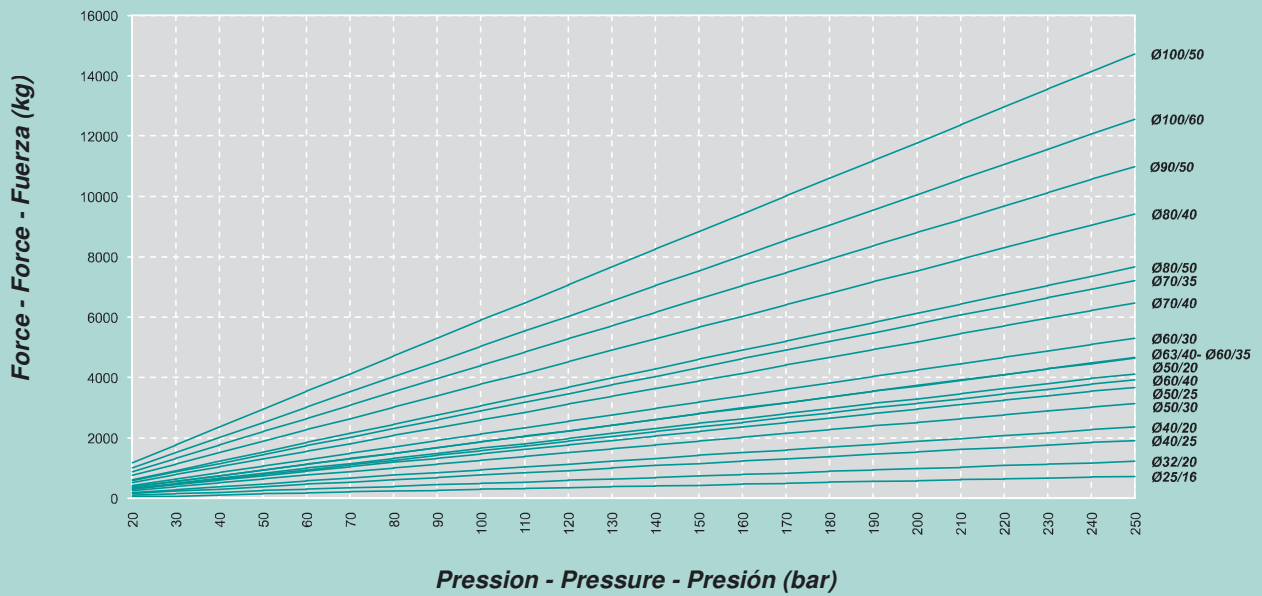

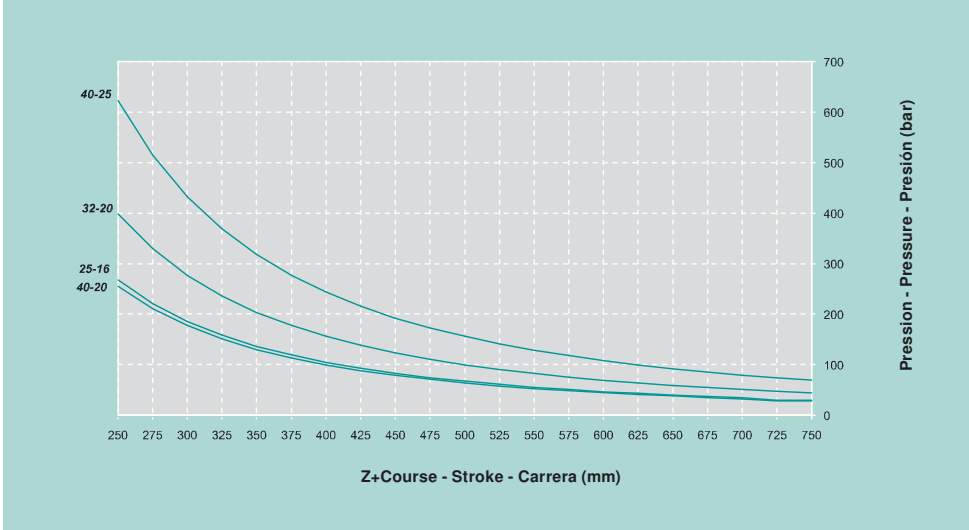

FLAMBAGE TIGE VERINS
STANDARD TYPE HMO
(Alésage 25-32-40 mm)

COMBINED COMPRESSIVE AND
BENDING STRESS ON STANDARD
CYLINDERS HMO TYPE
(Bore 25-32-40 mm)

CARGA DE PICO CILINDROS
ESTANDAR TIPO HMO
(dia. Interior 25-32-40 mm)

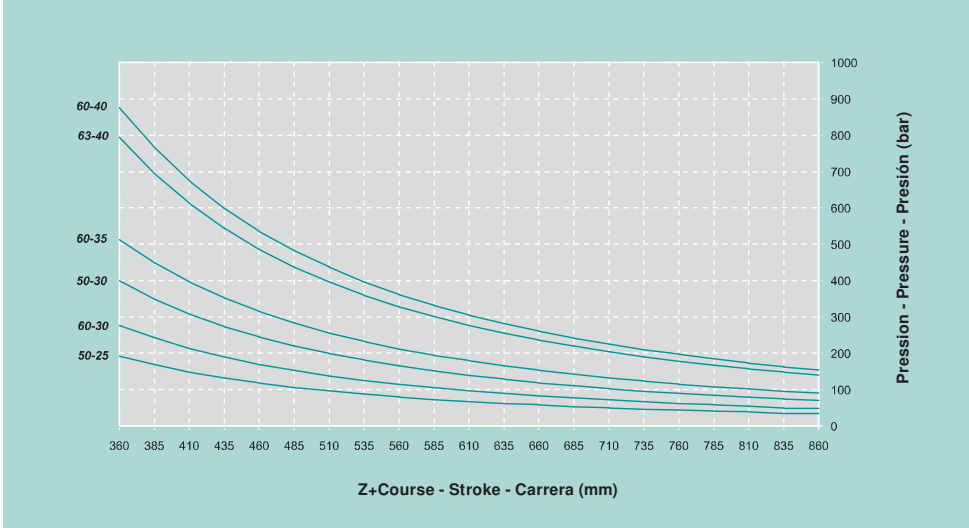

FLAMBAGE TIGE VERINS
STANDARD TYPE HMO
(Alésage 50-60-63 mm)

COMBINED COMPRESSIVE AND
BENDING STRESS ON STANDARD
CYLINDERS HMO
TYPE (Bore 50-60-63 mm)

CARGA DE PICO CILINDROS
ESTANDAR TIPO HMO
(dia. Interior 50-60-63 mm)



FLAMBAGE TIGE VERINS
STANDARD TYPE HMO
(Alésage 70-80-90-100 mm)

COMBINED COMPRESSIVE AND
BENDING STRESS ON STANDARD
CYLINDERS HMO TYPE
(Bore 70-80-90-100 mm)

CARGA DE PICO CILINDROS
ESTANDAR TIPO HMO
(dia. Interior 70-80-90-100 mm)

CARACTERISTIQUES TECHNIQUES
TECHNICAL SPECIFICATIONS
CARACTERISTICAS TECNICAS

TYPE "HMO" - "HMOLM"

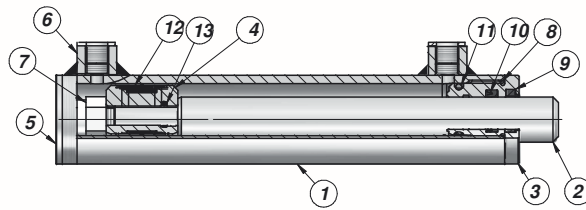

"HMO" Pression Maxi - Max. Pressure - Presión Máxima: 210 Bar
"HMOLM" Pression Maxi - Max. Pressure - Presión Máxima: 180 Bar

TYPE "HFR2S"

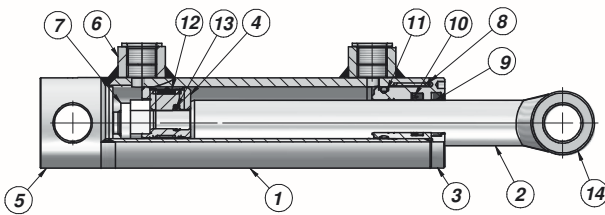

"HFR2S" Pression Maxi - Max. Pressure - Presión Máxima: 210 Bar

TYPE "HMF"

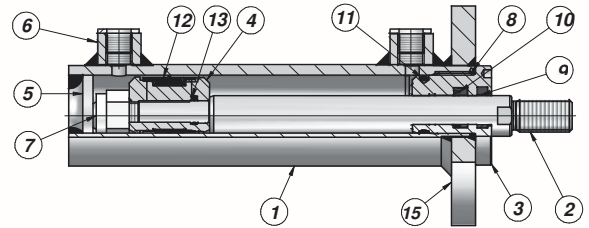

"HMF" Pression Maxi - Max. Pressure - Presión Máxima: 210 Bar

1	TUBE GLACE POLISHED TUBE - TUBO LUCIDO	ACIER - STEEL - ACERO: St 52.3 DIN 2393 ISO H9
2	TIGE CHROME CHROMED ROD - BARRACROMADA	ACIER - STEEL - ACERO: UNI C45 - SAE 1045 CHROME - CHROME - CROMO: 25 Micron ±5
3	TETE DE GUIDAGE HEAD-BUSH - CABEZA GUIA	FONTE - HYDRAULICCAST IRON - HIERRO FUNDIDO: UNI 5007-G25
4	PISTON	ACIER - STEEL - ACERO: 9SMn28
5	FOND - END-PLUG - FONDO	ACIER - STEEL - ACERO: S355J0 (Fe510C) - S355JR(A105)
6	BOSSAGE TARAUDE THREADED PORT - MANGUITOROSCADO	ACIER - STEEL - ACERO: 9SMn28
7	ECROU DE BLOCAGE PISTON LOCKNUT - TUERCA	ACIER - STEEL - ACERO: UNI 7473 - 7474
8	JOINT - SEAL - JUNTA O-RING	NBR 70 SHORE
9	JOINT - SEAL - JUNTA "GHK"	POLYURETHANE - POLYURETHANE - POLIURETANO
10	JOINT - SEAL - JUNTA "TSE-TTS-TTI/L"	"TSE": NBR+TISSU - NBR+FABRIC - NBR+TEJIDO "TTS-TTI/L": POLYURETHANE - POLYURETHANE - POLIURETANO
11	JOINT - SEAL - JUNTA O-RING	NBR 70 SHORE
12	JOINT - SEAL - JUNTA "TPM"	NBR+POM+POLYESTER - NBR+POM+POLYESTER - NBR+POLIÉSTER
13	JOINT - SEAL - JUNTA O-RING	NBR 70 SHORE
14	DOUILLE - BUSH - CASQUILLO PARA SOLDAR	ACIER - STEEL - ACERO: S355J0 (Fe510C)
15	BRIDE - FLANGE - BRIDA	ACIER - STEEL - ACERO: S355J0 (Fe510C)

Vitesse Maxi - Top Speed - Velocidad de pico: max 0,5 m/s
Température C° - Temperature C° - Temperatura C°: -25°C - +80°C

TYPE "HTO"

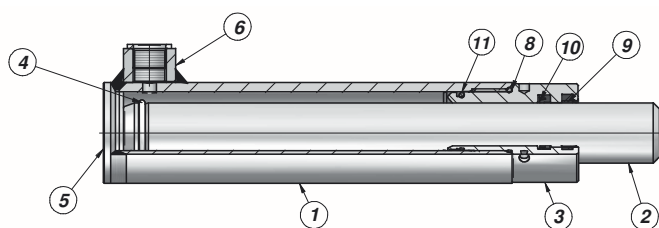

"HTO" Pression Maxi - Max. Pressure - Presión Máxima: 210 Bar

TYPE "HFRT"

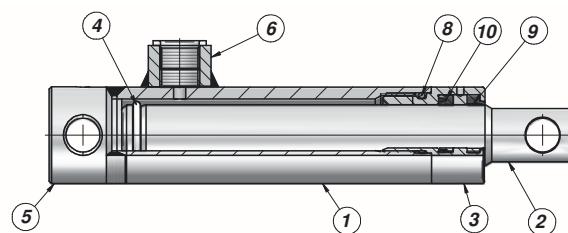

"HFRT" Pression Maxi - Max. Pressure - Presión Máxima: 210 Bar

1	TUBE GLACE POLISHED TUBE - TUBO LUCIDO	ACIER - STEEL - ACERO: St 52.3 DIN 2393 ISO H9
2	TIGE CHROMEE CHROMED ROD - BARRACROMADA	ACIER - STEEL - ACERO: UNI C45 - SAE 1045 CHROME - CHROME - CROMO: 25 Micron ±5
3	TETE DE GUIDAGE HEAD-BUSH - CABEZA GUIA TYPE - TYPE - TIPO: "HTO"	FONTE - HYDRAULICCAST IRON - HIERRO FUNDIDO: UNI 5007-G25
3	TETE DE GUIDAGE HEAD-BUSH - CABEZA GUIA TYPE - TYPE - TIPO: "HFRT"	ACIER 9SMn28 AVEC TRAITEMENT "NI-TEMPER" STEEL 9SMn28 WITH "NI-TEMPER" TREATMENT ACERO 9SMn28 CON TRATAMIENTO "NI-TEMPER"
4	JONC D'ARRETTIGE - STOP RING - ANILLO DE BLOQUEO	ACIER - STEEL - ACERO:
5	FOND - END-PLUG - FONDO	ACIER - STEEL - ACERO: S355J0 (Fe510C) - S355JR (A105)
6	BOSSAGE TARAUDE THREADED PORT - MANGUITO ROSCADO	ACIER - STEEL - ACERO: 9SMn28
8	JOINT - SEAL - JUNTA TIPO - TYPE - TYP: "HTO" O-RING	NBR 70 SHORE
8	JOINT - SEAL - JUNTA TIPO - TYPE - TYP: "HFRT" O-RING	NBR 90 SHORE
9	JOINT - SEAL - JUNTA "GHK"	POLYURETHANE - POLYURETHANE - POLIURETANO
10	JOINT - SEAL - JUNTA "TSE-TTS-TTI/L"	"TSE": NBR+TISSU - NBR+FABRIC - NBR+TEJIDO "TTS-TTI/L": POLYURETHANE - POLYURETHANE - POLIURETANO
11	JOINT - SEAL - JUNTA O-RING	NBR 70 SHORE

Vitesse Maxi - Top Speed - Velocidad de pico: max 0,5 m/s
Température C° - Temperature C° - Temperatura C°: -25°C - +80°C

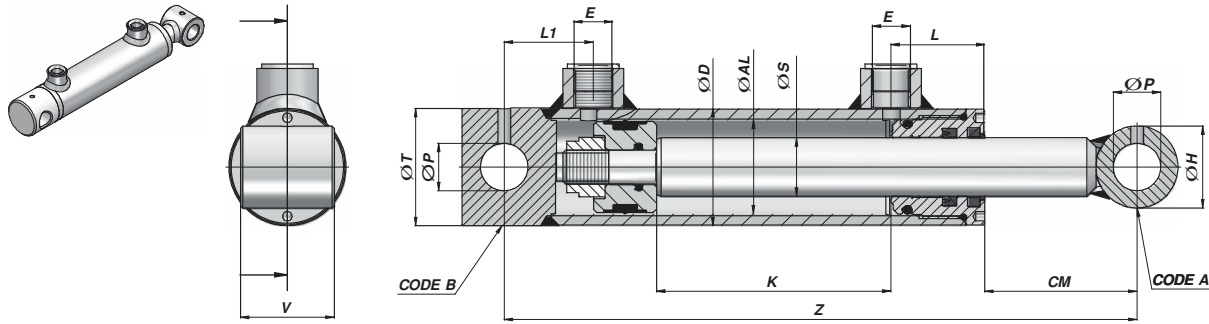

Code Code Código	K	Z	kg	E BSP	L	L1	CM	ØP	ØH	V	ØT	Code A	Code B	Code Code Código	K	Z	kg
ØD 35 ØAL 25 ØS 16																	
HFR0160050	50	160	1,00														
HFR0160100	100	210	1,20														
HFR0160150	150	260	1,40														
HFR0160200	200	310	1,70	1/4"	33	22	31	12,1	25	25	35	CBF0012025025	CFHR035025				
Kit de joints HFR: GKG025016																	
ØD 42 ØAL 32 ØS 20																	
HFR0200050	50	205	1,70														
HFR0200100	100	255	2,10														
HFR0200150	150	305	2,40														
HFR0200200	200	355	2,80														
HFR0200250	250	405	3,10	1/4"	33	35	51	16,2	30	35	40	CBF0016030035	CFHR040032				
HFR0200300	300	455	3,50														
HFR0200400	400	555	4,20														
HFR0200500	500	655	4,80														
Kit de joints HFR: GKG0032020																	
ØD 50 ØAL 40 ØS 25																	
HFR2S0400250100	100	270	3,00														
HFR2S0400250150	150	320	3,40														
HFR2S0400250200	200	370	3,90														
HFR2S0400250250	250	420	4,40														
HFR2S0400250300	300	470	4,80														
HFR2S0400250400	400	570	5,80	3/8"	40	38	65	20,25	35	40	50	CBF1020035040	CFHR040020040				
HFR2S0400250500	500	670	6,70														
HFR2S0400250600	600	770	7,60														
HFR2S0400250700	700	870	8,60														
HFR2S0400250800	800	970	9,50														
HFR2S0400251000	1000	1170	11,7														
Kit de joints HFR2S: GKGCTLM040015+GKGCG040025 Kit de joints HFR: GKG0040025																	
ØD 60 ØAL 50 ØS 30																	
HFR2S0500300100	100	300	4,40														
HFR2S0500300150	150	350	5,00														
HFR2S0500300200	200	400	5,60														
HFR2S0500300250	250	450	6,20														
HFR2S0500300300	300	500	6,90														
HFR2S0500300400	400	600	8,10	3/8"	43	42	85	25,25	40	45	60	CBF1025040045	CFHR050025049				
HFR2S0500300500	500	700	9,30														
HFR2S0500300600	600	800	10,50														
HFR2S0500300700	700	900	11,80														
HFR2S0500300800	800	1000	13,00														
HFR2S0500300900	900	1100	14,20														
HFR2S0500301000	1000	1200	15,50														
Kit de joints HFR2S: GKGCTLM050021+GKGCG050030 Kit de joints HFR: GKG0050030																	

M250

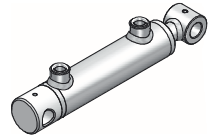
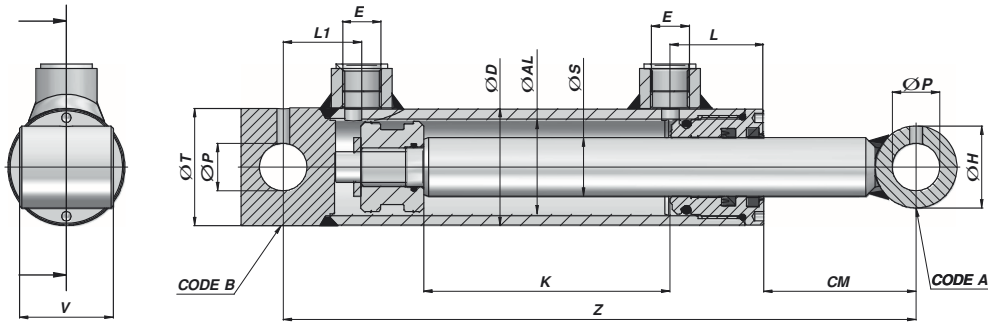

Code Code Código	K	Z	kg	E BSP	L	L1	CM	ØP	ØH	V	ØT	Code A	Code B	Code Code Código	K	Z	kg				
ØD 70 ØAL 60 ØS 30														ØD 70 ØAL 60 ØS 35							
HFR2S0600300100	100	300	5,60	3/8"	50	36	83	25,25	40	45	70	CBF1025040045	CFHR060025047	HFR2S0600350200	200	400	7,50				
HFR2S0600300150	150	350	6,30											HFR2S0600350300	300	500	9,00				
HFR2S0600300200	200	400	7,00											HFR2S0600350400	400	600	10,60				
HFR2S0600300250	250	450	7,70											HFR2S0600350500	500	700	12,10				
HFR2S0600300300	300	500	8,30											HFR2S0600350600	600	800	13,70				
HFR2S0600300350	350	550	9,00											HFR2S0600350700	700	900	15,20				
HFR2S0600300400	400	600	9,70											HFR2S0600350800	800	1000	16,80				
HFR2S0600300450	450	650	10,40											HFR2S0600350900	900	1100	18,30				
HFR2S0600300500	500	700	11,00											HFR2S0600351000	1000	1200	19,90				
HFR2S0600300600	600	800	12,40																		
HFR2S0600300700	700	900	13,70																		
				Kit de joints HFR2S: GKGB060024+GKGC060030 GKGB060024+GKGC060035 Kit de joints HFR: GKG0060030 GKG0060035																	
ØD 80 ØAL 70 ØS 40																					
HFR2S0700400200	200	410	10,10	3/8"	50	46	82	30,25	50	55	80	CBF1030050055	CFHR070030063								
HFR2S0700400250	250	460	11,00																		
HFR2S0700400300	300	510	12,00																		
HFR2S0700400350	350	560	13,00																		
HFR2S0700400400	400	610	13,90																		
HFR2S0700400450	450	660	14,90																		
HFR2S0700400500	500	710	15,80																		
HFR2S0700400600	600	810	17,70																		
HFR2S0700400700	700	910	19,60																		
HFR2S0700400800	800	1010	21,50																		
HFR2S0700400900	900	1110	23,40																		
				Kit de joints HFR2S: GKGB070024+GKGC070040 Kit de joints HFR: GKG0070040																	
ØD 92 ØAL 80 ØS 40																					
HFR2S0800400200	200	410	13,00	3/8"	60	42	70	30,25	50	55	90	CBF1030050055	CFHR080030060								
HFR2S0800400250	250	460	14,20																		
HFR2S0800400300	300	510	15,30																		
HFR2S0800400350	350	560	16,40																		
HFR2S0800400400	400	610	17,50																		
HFR2S0800400500	500	710	19,80																		
HFR2S0800400600	600	810	22,00																		
HFR2S0800400700	700	910	24,30																		
HFR2S0800400800	800	1010	26,50																		
HFR2S0800400900	900	1110	28,80																		
HFR2S0800401000	1000	1210	31,00																		
				Kit de joints HFR2S: GKGB080027+GKGC080040 Kit de joints HFR: GKG0080040																	
ØD 115 ØAL 100 ØS 50																					
HFR2S1000500200	200	425	21,50	1/2"	66	45	75	30,25	60	70	115	CBF1030060070	CFHR100300063								
HFR2S1000500300	300	525	25,00																		
HFR2S1000500400	400	625	28,50																		
HFR2S1000500500	500	725	32,00																		
HFR2S1000500700	700	925	39,10																		
HFR2S1000500900	900	1125	46,10																		
HFR2S1000501000	1000	1225	49,60																		
														Kit de joints HFR2S: GKGB100033+GKGC0100050 Kit de joints HFR: GKG0100050							

MATERIEL - MATERIAL:

TUBE - TUBE - TUBO: ACIER - STEEL - ACERO St 52.3 DIN 2393 ISO H9

TIGE - ROD - VASTAGO: ACIER - STEEL - ACERO UNI C45 SAE 1045 - CHROME - CHROME - CROMO: 25 MICRON ±5